

Figure 100

Figure 100 is an economical union with precision machined metal-to-metal sealing surfaces. Recommended for water, oil or gas up to 1,000 PSI NSCWP.



Standard Service		H2S Service	
NSCWP	Test	NSCWP	Test
1,000 PSI	1,500 PSI	1,000 PSI	1,500 PSI

*All Working Pressures are Non-shock Cold Working Pressure Ratings (NSCWP)

Figure 100 Threaded Color Code: Yellow Subs/Black Nut

Nominal Pipe Size	2"	2 1/2"	3"	4"	5"	6"	8"
Qty. / Box Part No.	16 U010200	8 U012500	6 U010300	4 U010400	2 U010500	1 U010600	1 U010800
Clearance Radius (A)	2.91"	3.66"	4.00"	4.69"	5.20"	6.97"	7.67"
End to End Threaded (B)	3.63"	4.38"	5.07"	6.24"	6.58"	7.10"	8.60"
Weight (lbs)	6.10	10.75	14.50	22.40	31.00	47.00	60.00
Material, Sub Material, Nut	A105 A105	A105 A395 D.I.	A105 A105	A395 D.I. A395 D.I.	A395 D.I. A395 D.I.	A395 D.I. A395 D.I.	A395 D.I. A395 D.I.

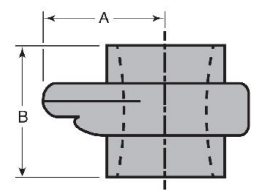

Figure 100 Butt Weld Schedule 80* Color Code: Yellow Subs/Black Nut

Nominal Pipe Size	2"	3"	4"	6"	8"
Qty. / Box Part No.	16 U010220	6 U010320	4 U010420	1 U010620	1 U010820
Clearance Radius (A)	2.91"	4.00"	4.69"	6.97"	7.67"
End to End (B)	3.79"	4.80"	4.98"	7.56"	7.31"
Weight (lbs)	6.63	16.00	23.50	54.00	80.00
Material, Sub Material, Nut	A105 A105	A105 A105	A105 A395 D.I.	A105 A105	A105 A395 D.I.

*Schedule 40 available upon request
Availability in Socket Weld varies per size

